



DENALI Plow Mount MA11700 Polaris Ranger Full Size, Crew Polaris RZR

Thank you for purchasing our DENALI plow mount. You now own a premium custom plow mount to allow you to use your plow with your SxS. Please note the following instructions and heed all warnings.

- Your UTV/SxS and/or plow system can cause death or injury, please use caution and common sense when operating your unit.
- Read your Plow Operator Manual, your Winch Operator Manual, and all warning labels before operating your UTV/SxS.
- Operate your UTV/SxS at a walking speed with the blade installed. Do not exceed 5 mph (8 km/h), even with the blade up.
- Do not operate the UTV/SxS on slopes greater than 10 degrees with the plow installed.
- Always lower the plow to the down position before leaving your UTV/SxS unattended.

SEVERE INJURY OR DEATH MAY RESULT IF YOU ARE NEGLIGENT.

Please verify that all hardware and parts are included in your package.

Kit Contents:

Item Number	Quantity	Part Number
1	1	MA11700 Plow Mount
2	1	Rear Buckle
3	3	Front Nuts
4	5	3/8" x 1 1/4" HH G5 Bolt
5	5	3/8" Lock Washers
6	5	3/8" Flat Washers
7	5	3/8" Nylock Nut (Not Shown)

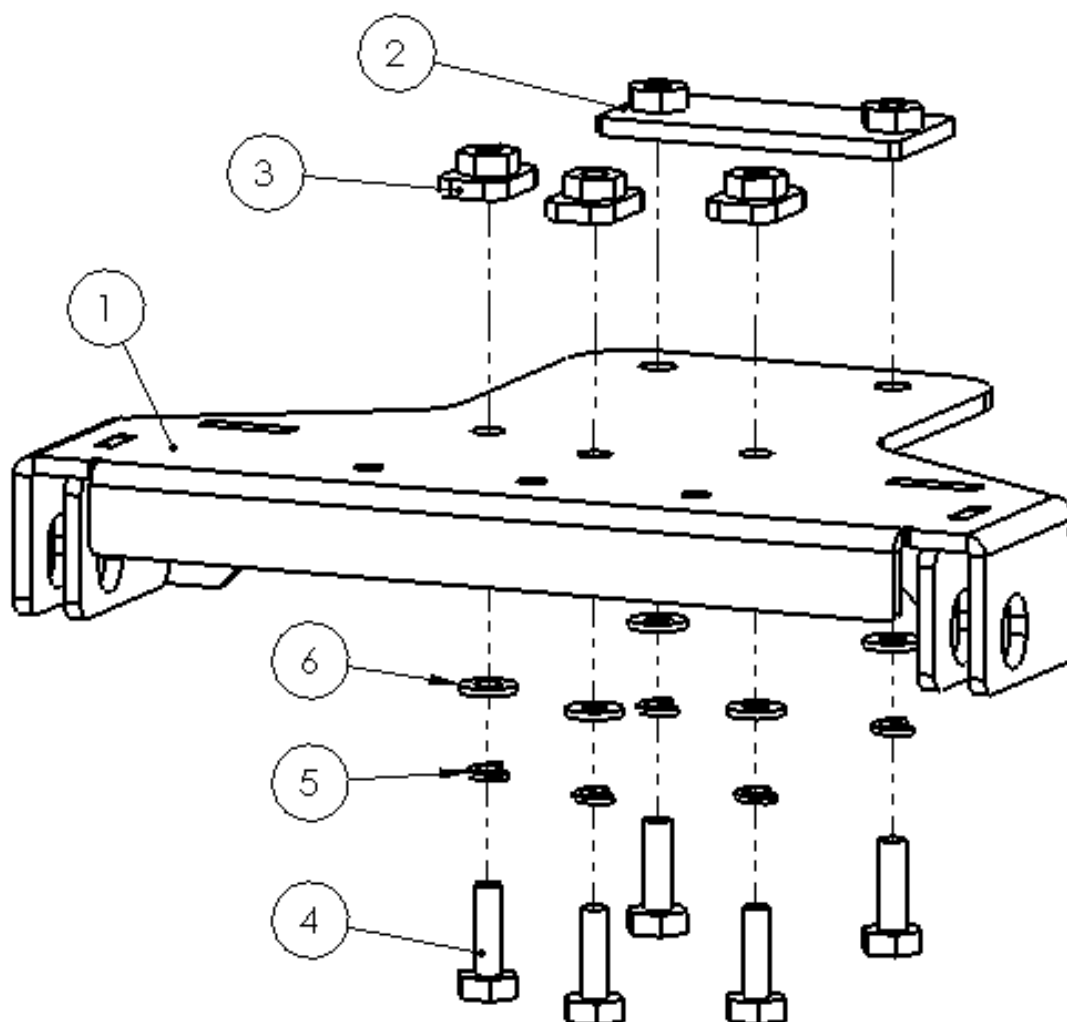

Figure 1

Note: The MA11700 Plow Mount fits both Polaris Ranger and RZR

Polaris RZR Installation Instructions

1. Set the Rear Buckle behind the differential of your RZR and between the two chassis tubes. Place it over the first set of larger holes in the bottom of the RZR, see **Figure 2**.



Figure 2

2. Hold the mount up to the base of your RZR so that the rear holes in the mount line up with the Rear Buckle holes. Use two of the 3/8" Hex Head Bolts, Lock Washers, and Flat Washers to loosely secure the plow mount to the Rear Buckle, See **Figure 3**.
3. **Note: Do not tighten at this time**



Figure 3



3. Insert the three Front Nuts into the space just in front of the differential. With your finger or screw driver, position them over the three holes in the underbody. Push the plow mount up to the underbody and align the middle set of holes with the holes in the underbody. Use the remaining 3/8" Bolts, Lock Washers, and Flat Washers to secure the front of the mount. The two outer Front Nuts will not spin as they are designed to hit the chassis when tightened. The middle nut will need to be secured with a wrench to tighten. See **Figure 3**.
4. Verify that all bolts are tight, install your plow push tubes using the quick release pins in the pushtube kit. Be sure to attach the large washers (Included in the Denali pushtube kit) after the quick release pins are installed. The holes in your plow mount have been slotted intentionally to allow your plow blade to flex with the ground as you travel, ultimately providing a much cleaner cut path. **The washers ensure that the quick release pins cannot become dislodged during operation. For this reason they are essential.**

Note: The MA11700 Plow Mount fits both Polaris Ranger and RZR

Polaris Ranger Installation

1. Attach the plow mount to the underside of the Ranger using the front three holes found on the Plow Mount and the corresponding holes in your Ranger. Use three of the 3/8" x 1 1/4" Hex Bolts, Flat Washers, Lock Washers and Nylock nuts. **See Figure 4. Note: Plow mount image may differ slightly from image below.**
2. Attach the back of the mount using the Rear Buckle on the inside of the skid plate and secure it using the remaining 3/8" x 1 1/4" Hex Bolts, Flat Washers and Lock Washers. **See Figure 5.**
3. Tighten all the bolts securely.
4. Attach your Denali Plow System to the mount using the Quick Release Pins and Quick Release Pin Washers included with your plow kit (not included in this package).
5. After your first plowing, verify that all the bolts are secure.

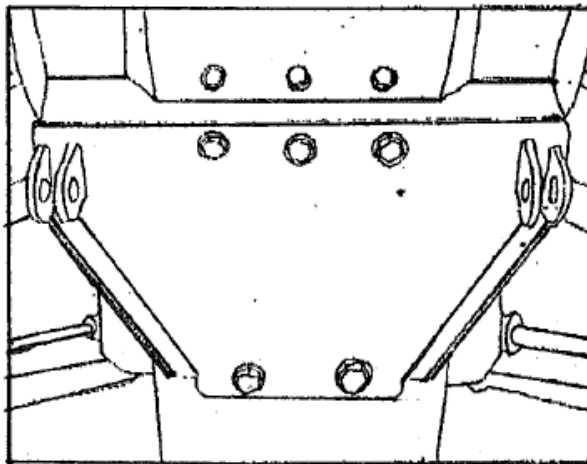

Figure 4

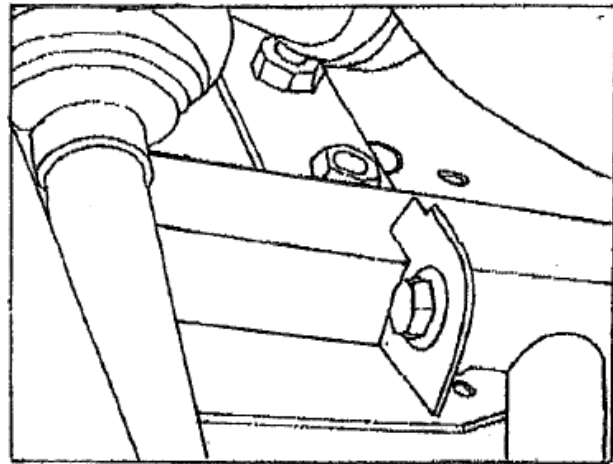

Figure 5